

All New A-series Wire Cut Linear Motors

Innovation Achievement Future

Advanced compact design

Saving space nearly 15% compared to conventional model.

Advanced rigidity and Thermal balanced structure.

The new "Traveling Wire" A Series A422SL is a Gantry style model where the workpiece is stationary and the wire moves through the workpiece.



LINEAR MOTOR

The Chmer built Linear Motors utilizing Panasonic Drives and Glass Scale feedback provide the optimum in positioning accuracy, repeatability and with virtually no backlash caused by ballscrews. Also, since there is no wear on the positioning mechanism, high precision is guaranteed for many years of service.

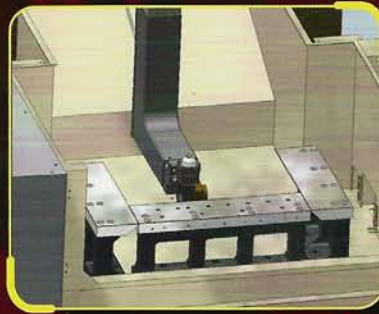

Unique slanted wire ejection design eliminates the back water seal plate that can cause drag on the lower arm resulting in inaccuracies in the cutting. Also, with no moving X or Y seals there are no replacement seals required.

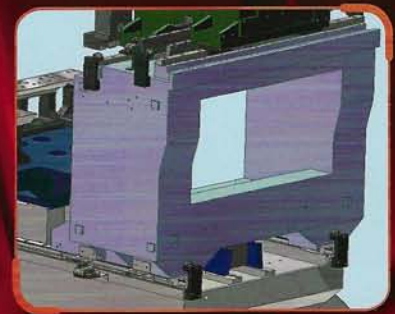

Worldwide AA+ grade Gantry column design guarantees full support for the wire transport resulting in higher accuracy with fewer passes.

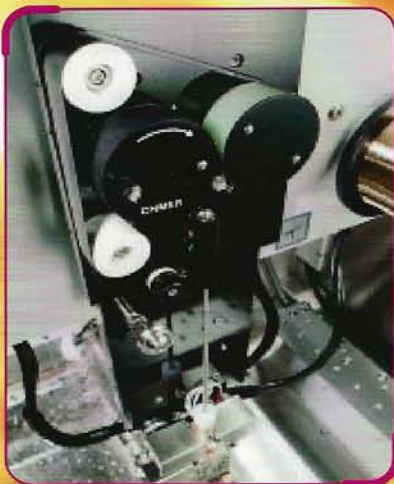

5th Generation AWT system

The unique Chmer AWT with the ability to auto thread the wire into very small start holes < .015" dia. As well as auto rethread the wire through the kerf, underwater and on location in less than 10 seconds! This AWT system does not require the wire to return to initial start point as required by most other wire EDMs.



To comply with the "going green" movement, Chmer has designed their new power supplies to achieve the same performance but with a 15% decrease in power consumption.



Specifications

Model		A422SL
Axis Travel(X×Y×Z)	mm	400×250×200
Auxiliary Table Travel(U×V)	mm	60×60
Max. Size of Workpiece	mm	800×560×195
Max. Weight of Workpiece	kg	550
X Y Feed Rate		Max. 1500 mm/min
Axis Drive System		X,Y axis by linear Motor; U,V,Z axis by AC Servo Motor
Wire Diameter Range(Standard)		Ø0.15-0.3mm (Ø0.25mm)
Max. Wire Feed Rate		300mm/sec
Wire Tension		300-2500gf
Taper Angle		±14.5°/80mm WIDE ANGLE NOZZLE
Machine Weight	Kg	2600
Working Fluid Supply Unit		
Tank Capacity		580L
Filter Element		Paper
Ion Exchange Resins		14L
Conductivity Control		Auto
Fluid Temperature Control		Auto
Power Supply Unit		
Circuit System		Power MOS Transistor
Max. Output Current		25A
IP Select		10
Off Time System		50
CNC Unit		
Data Input		Keyboard,RS-232C
Display		15-Inch Color
Control System		32bit,1-CPU,Closed Loop
Control Axis		X,Y,U,V,Z (opt B)
Setting Unit		0.001mm
Max. Command Value		±9999.999mm
Interpolation		Linear/Circular
Command System		ABS/INC
Machining Feed Control		Servo/Const. Feed
Scaling		0.001-9999.999
Machining EDM Condition Memory		1000-9999
Total AC Power Input		3 Phase 220 ±10%/13kva



WIRE FEEDER UNIT

Wire Feeder can supply wire continuously for over extended periods (About 150HR at 30 KG loading of wire electrode)

Standard Accessories

1. X, Y axis Linear Motor
2. Linear Scale .000020" resolution
3. AWT
4. Auto Vertical Alignment jig
5. Chiller
6. AVR Auto voltage regulator
7. AC-u Fine finish circuit

Optional

1. Ø 0.1 mm wire unit
2. Wire feeder unit
3. Wire Chopper
4. Bridge Rule
5. B-Axis (6th Axis Function)

Machine Layout

A422SL

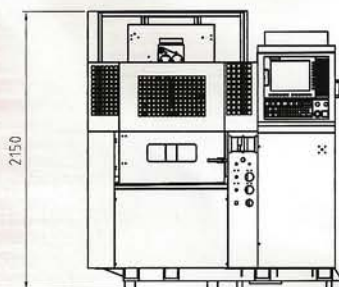

2400

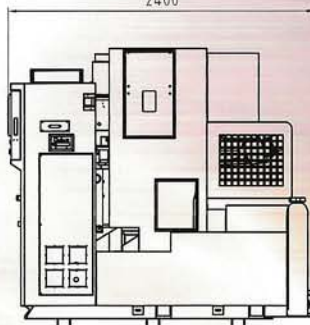

CHING HUNG MACHINERY & ELECTRIC INDUSTRIAL CO., LTD.

No.3, Jing-Ke 1st Road, Nantun District, Taichung City 408, Taiwan
 TEL:+886 4-23509188 FAX:+886 4-23500977
 http://www.chmer.com Email:overseas@mail.chmer.com

Agent / Distributor